



Display Home **The Chesterfield**

FOR SALE

**19 Moon St,
Leppington**

\$1,230,000



This four-bedroom display home offers contemporary living and quality finishes throughout, perfect for a new home buyer. It is situated in a quiet pocket in Leppington under 2km to the Train Station, 1km from Leppington Village Shopping Centre and various nearby schools.

The home includes:

- 2.7 High Ceiling's
- Upgraded with Total Opulence Collection
- Fully Ducted Actron Air Conditioning
- Downlights throughout
- Feature wall paneling.
- Custom cabinetry to family room
- Ceramic floor tiles to common areas.
- Carpet to remainder of house.
- Ceiling high wall tiling to ensuite & main bathroom.
- 5 sensor alarm package.
- Security Cameras
- Plantation Shutters to all windows (exc. wet area & garage).
- Flyscreens to all windows.
- Completely Furnished
- Landscaping
- Fencing
- And much much more..



301.8 m2 Block



4 Bed



2 Bath



1 Garage



3D Tour



02 8783 8800



myhome@casaview.com.au

DATA	
1. ground	136.28
2. garage	19.18
3. porch	1.91
4. alfresco	8.57
	165.94 m ²

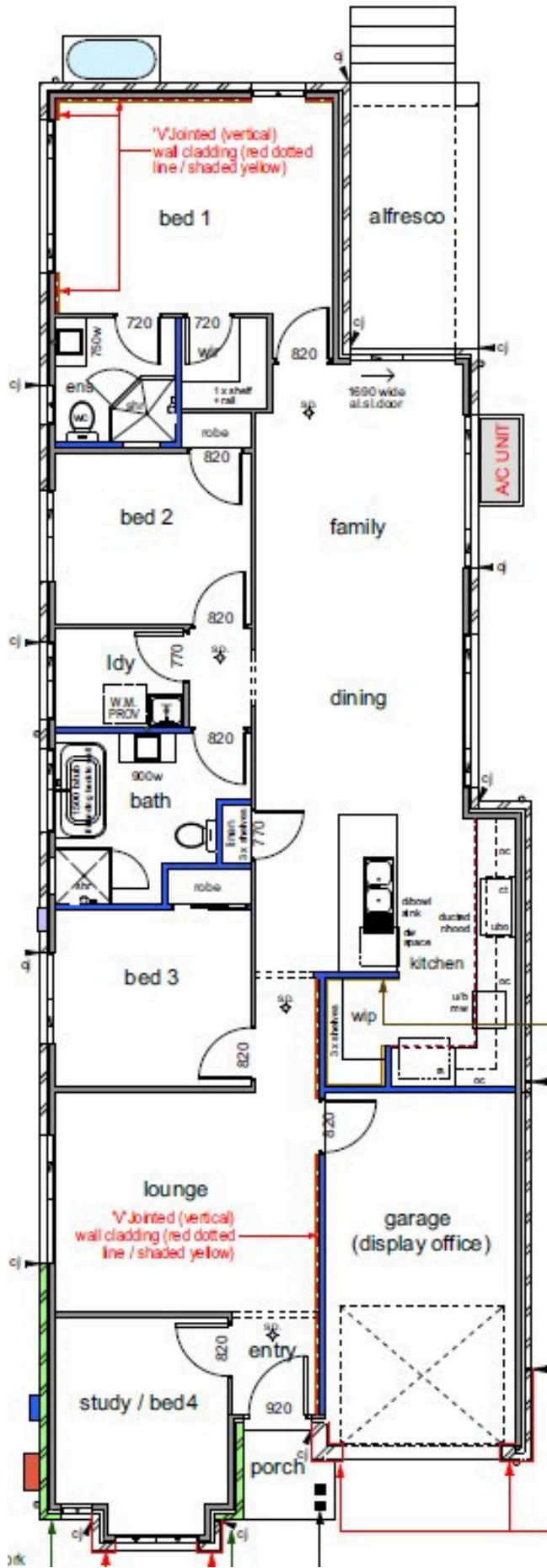

301.8 m² Block
 4 Bed
 2 Bath
 1 Garage



3D Tour



02 8783 8800



myhome@casaview.com.au