

THE MAYFIELD DUPLEX

Building With Excellence Since 1994



CASAVIEW
HOMES



CASAVIEW HOMES - 100% AUSTRALIAN OWNED & OPERATED

THE MAYFIELD

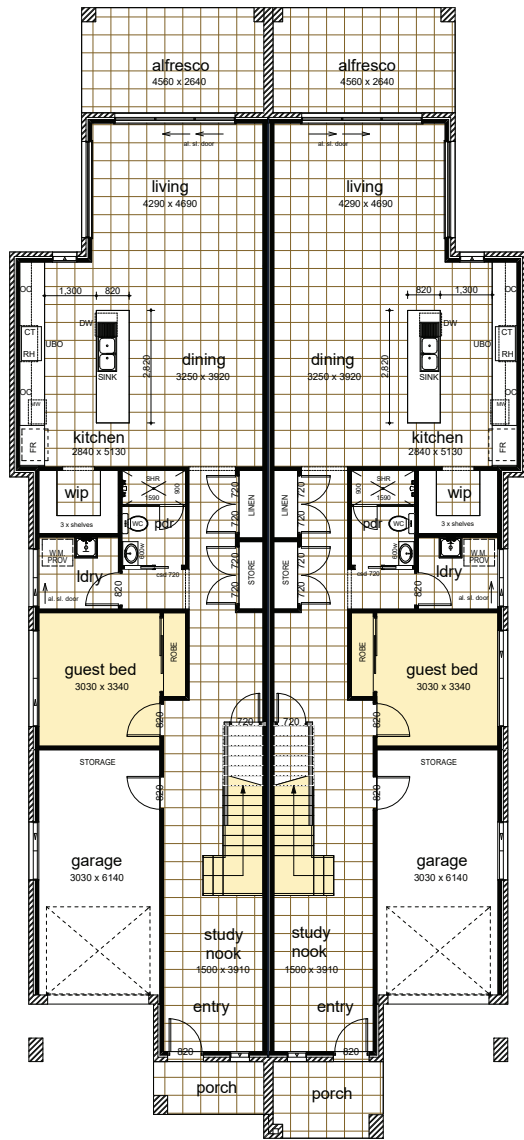

480 11,990 480
12,950

Ground Floor

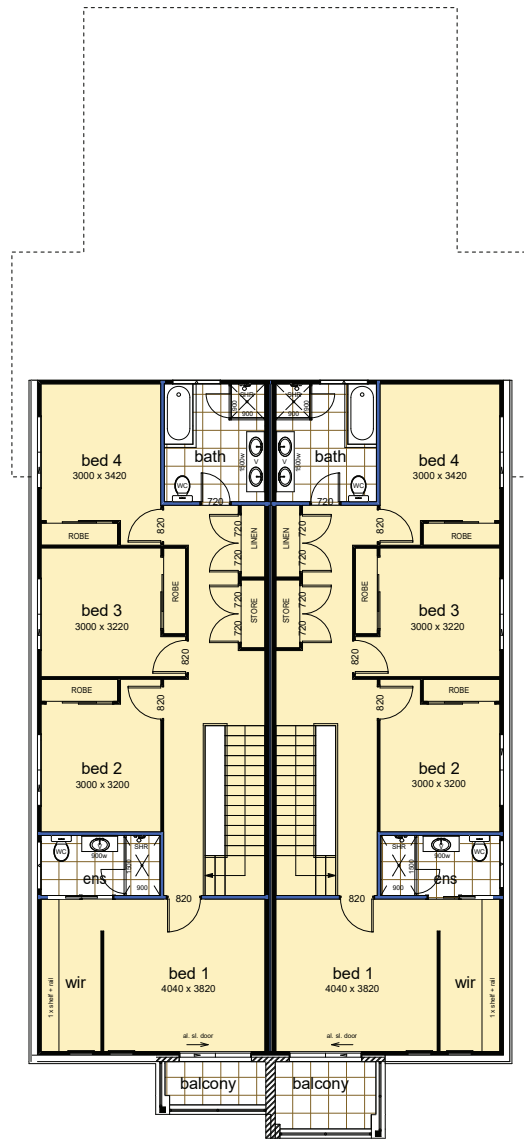

160 11,670 160

First Floor

PACKAGE INCLUDES:

- “Colour on” concrete driveway (up to 70 Sqm)
- Ceramic floor tiles to common areas
- Carpet to remainder of house
- Standard Basix costs
- 1200mm high wall ceramic tiling to bed 1 ensuite & main bathroom x 1
- 5 sensor alarm package
- Vertical blinds to all windows (exc. wet area & garage)
- Flyscreens to all windows
- Facade in face brick as designed
- Construction site fencing
- 32MPA salinity resistant house slab

DATA	UNIT A	UNIT B
Ground Floor	115.10	115.10
Garage	20.89	20.89
Porch	3.86	5.52
Covered Area	4.49	4.49
Alfresco	12.34	12.34
First Floor	99.07	99.07
Balcony	3.86	5.52
	259.61m²	262.93m²

TOTAL: 522.54m²

Suits 15m wide block.



Plans Copyright of Casaview Homes